

EXCLUSIVE WESTERN CARIBBEAN HIGH SEAS RALLY COVERAGE!

AMERICAN BAGGER

THE ORIGINAL AMERICAN V-TWIN PERFORMANCE TOURING & CUSTOMIZING AUTHORITY

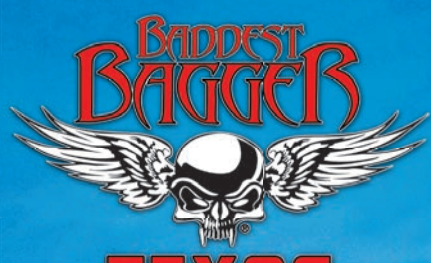

TEXAS

CRESER RAMIREZ'S
BADDEST BAGGER WINNING
2000 ROAD KING



TECH

**CENTRAMATIC
POLICE BIKE
CUSTOM**

BATTISTINIS CUSTOM CYCLES'
WIREFRAME SERIES FLOORBOARDS
& FOOT CONTROLS

**KLOCK WERKS
OVAL TAILLIGHTS**

**JIMS USA
FORCEFLOW CYLINDER
HEAD COOLER**

**HAWG WIRED
ZX SPEAKERS, CS300 AMPS
& RC-LINK CONTROLLER**

ISSUE 12 VOL 06 JANUARY 2013



KEEP ON SALE UNTIL JANUARY 31

HAWG WIRED

ZX SPEAKERS, CS300 AMPS & RC-LINK REMOTE

Story by Nate Kersjes – Photos by Jesse B. Nelson

This 2012 Street Glide is going to receive some more audio upgrades. This bike came in with Hawg Wired's speaker lids already installed. We will install Hawg Wired's new remote control link system with two CS300 amps and a set of ZX speakers. Their new system allows you to install up to four CS or RS amplifiers. The cool thing about this setup is that the four amps are connected to each other. The big inconvenience of multiple amps is adjusting them. Not only is it hard to adjust when you are hearing other speakers than the ones you are dialing in, but everything changes once the outer fairing is installed. The remote link system allows you to have everything buttoned up and still adjust your gain and frequency. The remote will control up to four amplifiers. Simply select which amp (1, 2, 3 or 4) you want to adjust. Once you have selected an amp, the controller turns the other amps off for easy tuning.



Hawg Wired's ZX speakers, RC-LINK remote and CS300 amplifiers



This 2012 FLHX will get front Hawg Wired speakers and amps to complement its speaker lids.



1 Remove the outer fairing mounting bolts.

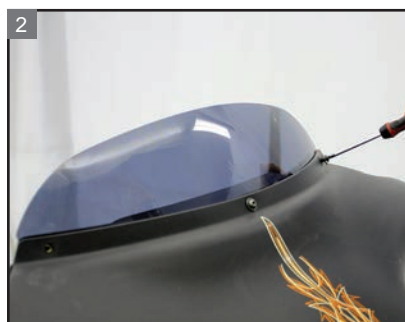

2 Remove the windshield mounting bolts and set the windshield aside.



3 Remove the outer fairing and set it aside.



4 Unplug the speaker wiring.



5 Remove the speaker mounting bolts.



6 Remove the fairing's support bracket mounting hardware and bracket.



7 Remove the stock speaker.



8 With a batwing fairing, stack the speaker adaptor rings like this.



9 Place the speaker grill onto the adaptor ring.



10 Position the adaptor ring so the longer portion faces forward.

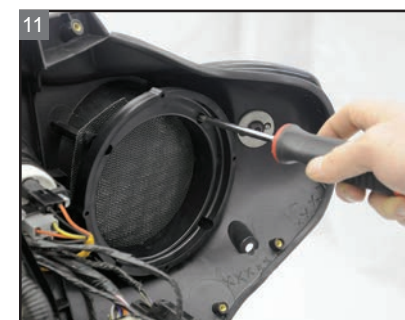

11 Install and tighten the adaptor ring's mounting hardware.



12 Install the foam gasket onto the speaker.



13 Position the speaker up to the adaptor ring.



14 Install and tighten the Hawg Wired speaker.



15 Remove the adhesive's backing and stick the crossover to the inner fairing.

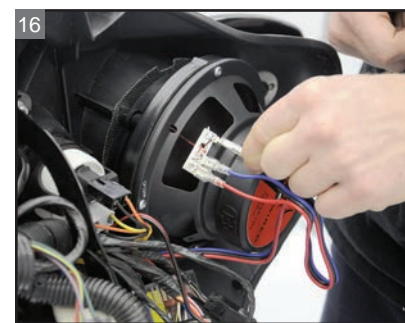

16 Plug the wiring from the crossover into the speaker.



17 Remove the seat and set it aside.

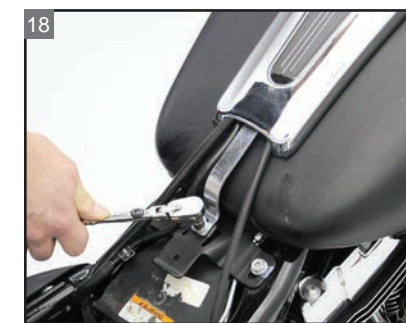

18 Loosen and remove the dash's mounting hardware.

HAWG WIRED

ZX SPEAKERS, CS300 AMPS & RC-LINK REMOTE



Remove the dash and set it aside.



Disconnect the fuel pump wiring.

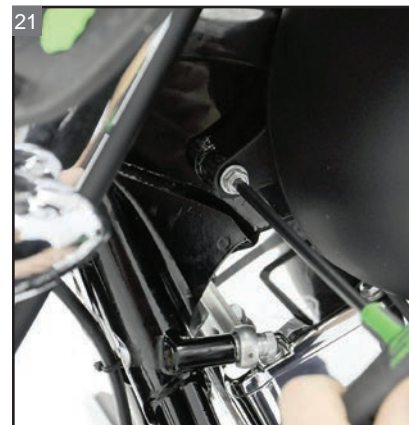

Remove the gas tank's mounting hardware.



Plug in the fuel pump wiring.



Install the dash onto the tank.



Install and tighten the dash's mounting hardware.



Disconnect the fuel line from the tank.



Remove the tank from the frame's backbone.

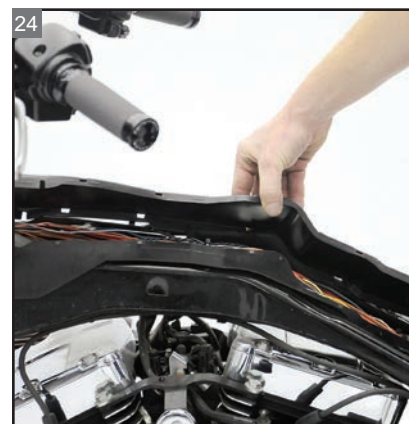

Remove the wire caddy lid.



Plug the fuel line into the quick disconnect.

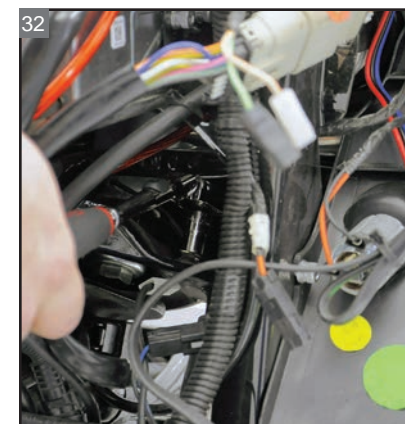

Remove the ground bolt from the triple tree.

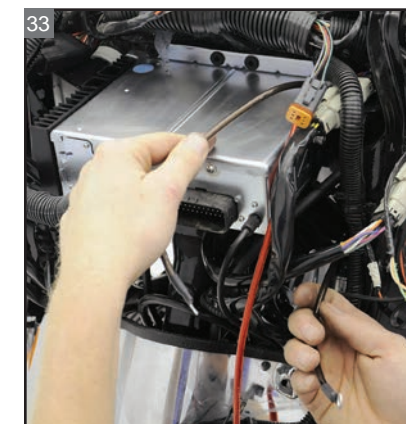

Route the ground wires from above the stereo deck to the ground bolt.



Install the amplifier power wires into the wire caddy.



Install the tank onto the backbone.



Install and tighten the tank's mounting hardware.

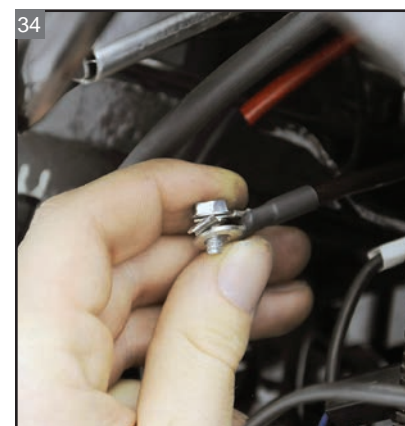

Install the ground wires onto the bolt and tighten the ground bolt.



Use isopropyl alcohol to clean the top of the stereo deck.



Stick the amp on top of the stereo deck.

HAWG WIRED

ZX SPEAKERS, CS300 AMPS & RC-LINK REMOTE



37 Connect the power and ground wires to the amplifier.

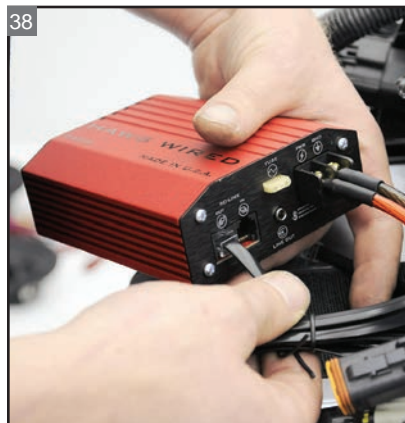

38 Plug the amp control wire into the OUT location (this will go to another amp).

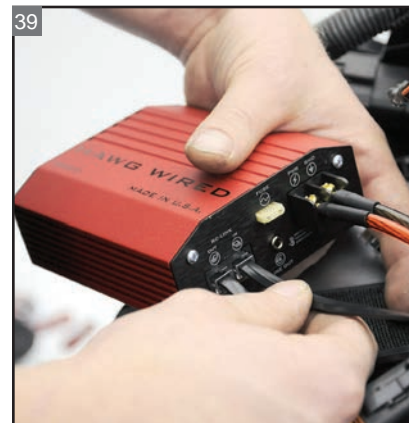

39 Plug a control wire into the IN position (this is where the remote will connect).

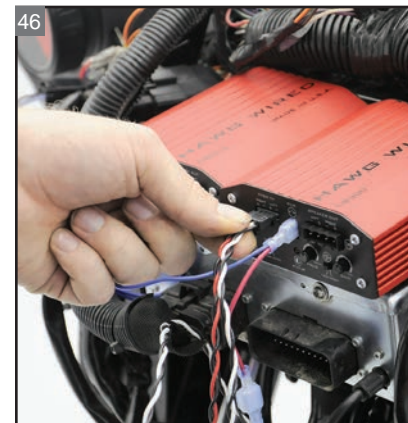

46 Plug in the amplifier's 'signal in' wiring harness.

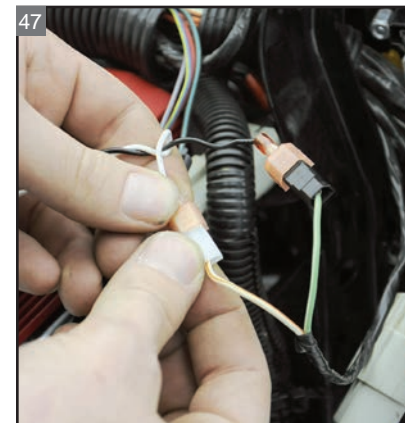

47 Plug the black and white wires from the 'signal in' harness into the stock speaker wires.

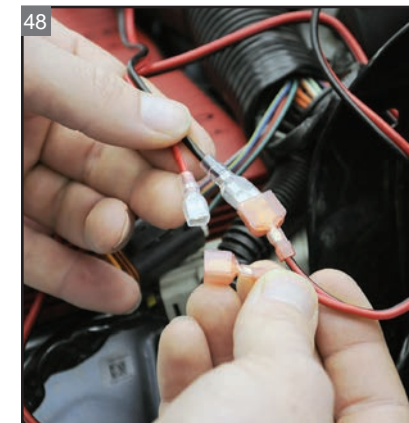

48 Connect the crossover wires into the amplifier's output wiring.



40 Plug the control wire from the other amp's OUT port into the IN port on the second amp.

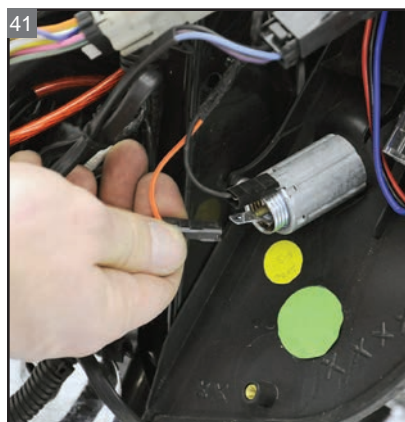

41 Remove the cigarette lighter power wire.

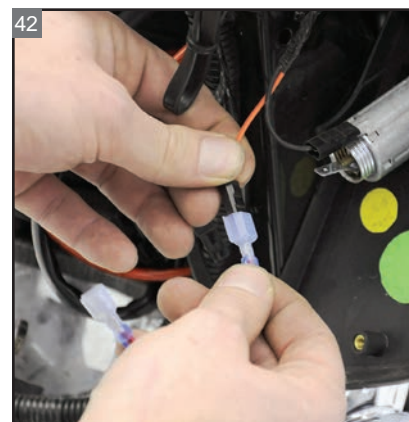

42 Connect the Y harness into the cigarette power wire.

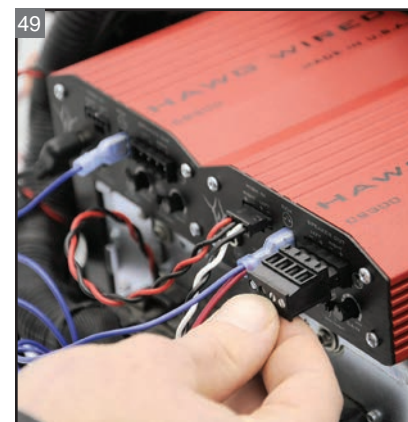

49 Install the amplifier's output connection block.

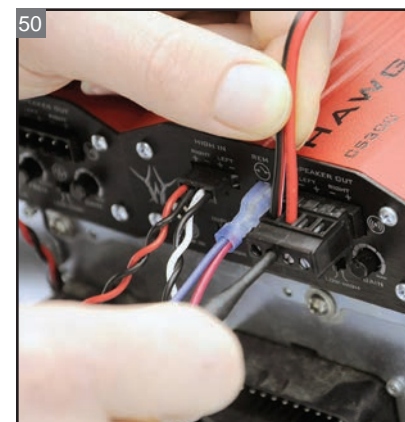

50 Install the wiring into the block and tighten the retaining screws.



51 Plug the speaker lids' wiring into the second amp.

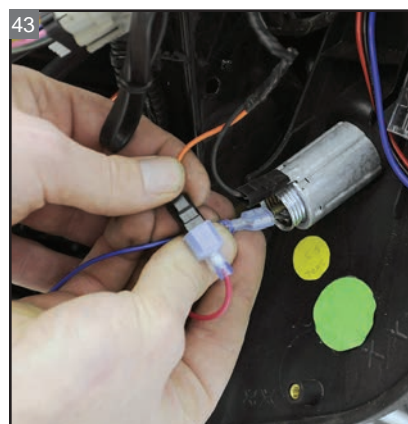

43 Connect another part of the Y harness into the cigarette lighter.

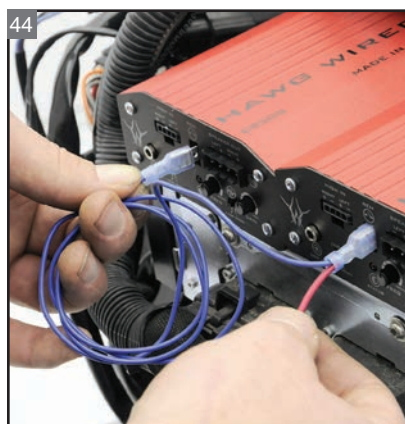

44 Plug the wires from the cigarette lighter into the REM (remote) port on the amp.



45 Plug in the LOW IN signal wire (this cable is from the back of the other amplifier).



52 Remove the ECM caddy's mounting bolts.



53 Lift the ECM caddy out of the way.

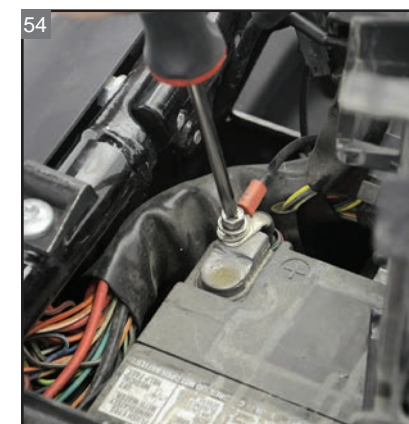

54 Loosen the battery's positive terminal.

HAWG WIRED

ZX SPEAKERS, CS300 AMPS & RC-LINK REMOTE



55 Install the amplifier power wires and tighten the battery bolt.



56 Install the ECM caddy and tighten the mounting bolts.



57 Install the fuses into the power wires.



58 Install the seat and mounting bolt.



59 Plug the junction block into the controller wire.



60 Tuck the connection block behind the wire harness.



61 Install the outer fairing.

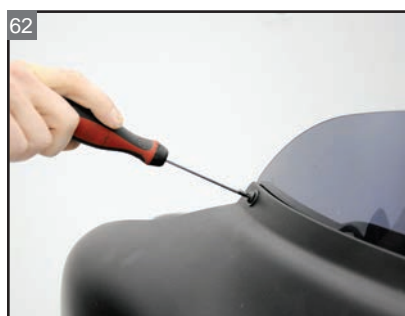

62 Install the windshield and mounting hardware.

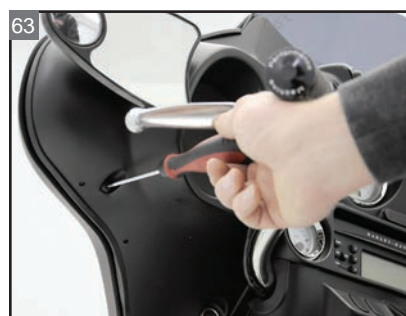

63 Install the outer fairing's mounting hardware.



64 Install the lower mounting bolts.



65 Plug the controller signal cable and power wire into the controller.



66 Plug the signal wiring into the junction block.



67 Plug the power wire into the cigarette lighter.



68 Adjust the amplifiers' gain and frequency.



The two amplifiers are dialed in yet ready for a quick adjustment if needed.

HAWG WIRED
 RC-LINK Remote
 Part #RC104
 CS300 Amplifiers
 Part #CS300
 6.5" ZX Speakers
 Part #ZX654-100

510.894.2999
www.hawg-wired.com